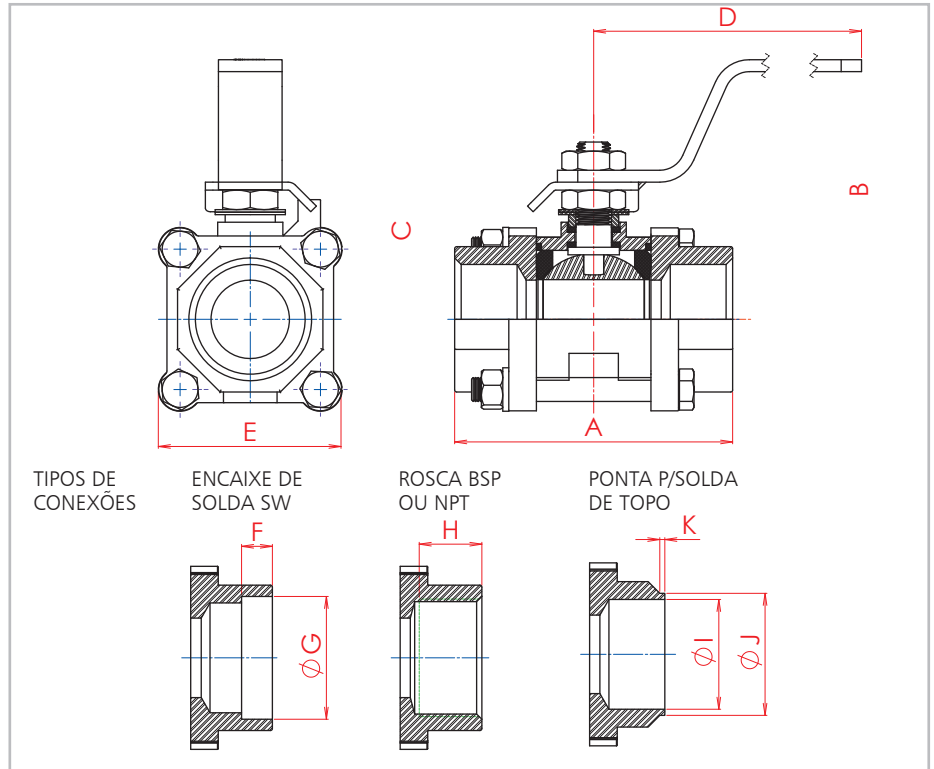

Foto Ilustrativa

Desenho Técnico

Normas de Referência

Construção
 BSI BS EN ISO 17292
 ASME B16.34
Testes
 API 598

Conexões

ROSCA BSP - ISO 228
 ROSCA NPT - ANSI/ASME 1.20.1
 SOLDA SW - ASME B16.11
 SOLDA BW - ASME B16.25

Materiais

Corpo e Tampas
 ASTM A 216 - WCB
 ASTM A 351 - CF8
 ASTM A 351 - CF8M
Haste
 ASTM A 276 - 304
 ASTM A 276 - 316
 SAE 1020
 ASTM A 276 - 410
 ASTM A 582 - 416

Esfera
 ASTM A 351 - CF8
 ASTM A 351 - CF8M
 ASTM A 217 - CA 15
 ICI 416
 ASTM B16 - C360

Vedações
 PTFE
 COMP L

Especificações Técnicas

- Válvula de bloqueio de fluxo Classe 300 indicada para utilização em diversos líquidos, gases e vapores em ampla faixa de temperatura e pressão conforme norma ASME B16.34.
- Construção tripartida (um corpo e duas tampas), facilitando a manutenção sem a necessidade de desconectar as extremidades da linha.
- Haste à prova de expulsão.
- Disponível na construção com dupla vedação, o que proporciona maior segurança quando utilizadas em linha de vapor.
- De fácil aplicação para trava de cadeado.

VÁLVULA DE ESFERA TRIPARTIDA PASSAGEM REDUZIDA (PR)														PESO kg	Coeficiente de Fluxo Kv (m ³ /h)
BITOLA		PASS.	A*	B	C	D	E	F	G	H	I	J	K		
POL.	DN														
1/2"	15	11,1	62,0	46,0	39,0	125,0	44,0	9,5	21,8	17,0	15,8	21,8	2,0	0,49	5,0
3/4"	20	14,0	71,6	48,0	41,0	125,0	48,0	12,5	27,1	17,0	20,9	27,1	2,0	0,61	9,8
1"	25	20,4	88,6	82,0	51,0	165,0	57,0	12,5	33,8	23,0	26,4	33,8	2,0	1,05	18,7
1.1/4"	32	25,4	101,0	86,0	60,0	165,0	64,0	12,5	42,6	23,0	35,0	42,6	2,0	1,40	42,0
1.1/2"	40	31,7	111,7	110,0	73,0	170,0	73,0	12,5	48,7	28,0	41,0	48,7	3,0	2,20	72
2"	50	38,0	121,5	113,0	77,0	170,0	82,0	16,0	61,0	28,0	52,5	61,0	3,0	2,90	107
2.1/2"	65	50,8	138,8	125,0	86,0	256,0	94,0	16,0	73,8	28,0	62,7	73,8	3,0	4,65	185
3"	80	63,0	176,5	145,0	116,0	267,0	116,0	16,0	90,1	37,0	78,0	90,1	3,0	8,70	305

VÁLVULA DE ESFERA TRIPARTIDA PASSAGEM PLENA (PP)														PESO kg	Coeficiente de Fluxo Kv (m ³ /h)
BITOLA		PASS.	A*	B	C	D	E	F	G	H	I	J	K		
POL.	DN														
1/4"	8	11,1	62,0	46,0	39,0	125,0	44,0	9,5	14,0	11,0	9,3	14,0	2,0	0,54	5,0
3/8"	10	11,1	62,0	46,0	39,0	125,0	44,0	9,5	17,6	11,0	12,3	17,6	2,0	0,52	5,0
1/2"	15	14,0	71,5	48,0	41,0	125,0	48,0	9,5	21,8	17,0	15,8	21,8	2,0	0,65	14,6
3/4"	20	20,4	88,6	82,0	51,0	165,0	57,0	12,5	27,1	17,0	20,9	27,1	2,0	1,13	27,8
1"	25	25,4	101,0	86,0	60,0	165,0	64,0	12,5	33,8	23,0	26,4	33,8	2,0	1,60	56,5
1.1/4"	32	31,7	111,7	110,0	73,0	170,0	73,0	12,5	42,6	23,0	35,0	42,6	2,0	2,55	104
1.1/2"	40	38,0	121,5	113,0	77,0	170,0	82,0	12,5	48,7	28,0	41,0	48,7	3,0	3,30	161
2"	50	50,8	138,8	125,0	86,0	256,0	94,0	16,0	61,0	28,0	52,5	61,0	3,0	5,20	278
2.1/2"	65	63,0	176,5	145,0	116,0	267,0	116,0	16,0	73,8	28,0	62,7	73,8	3,0	9,38	460

A vazão apresentada em Kv (m³/h) corresponde a um diferencial de pressão (Δp) de 1 bar utilizando água como fluido de teste.
 * Para conexão BW, medidas sob consulta.